

ROOKSDOWN REPORTER

Issue 4

Spring 2010



Brought to you by
Rooksdow
Parish Council

Delivered by the Rooksdow Community Association

EDITORIAL

Welcome to the fourth edition of the Rooksdown Reporter, I hope you enjoy it. Do you have any issues, stories or advertisements for the next issue of the Rooksdown Reporter?

If so, please get in touch: editor@rooksdwn.org.uk.

As well as the Rooksdown Reporter, there are a number of ways to find out what is happening in Rooksdown:

- Occasional Rooksdown articles in the Gazette contributed by Genni Dady.
- There is also a website : www.rooksdwn.org.uk

There are notice boards around Rooksdown,

- Situated by the telephone box Gillies Drive,
- The side of the Community Hut next to Mill Road Park,
- Park Prewett Road next to the Rooksdown Doctors Surgery
- Mill Road pathway

Note from the Editor - Jayne

Parking continues to be an issue in all areas of Rooksdown. Residents are asked to park considerately and not to obstruct pavements or access to other properties, and to avoid parking close to junctions which can obscure the sight-lines and increase the risk of accidents between cars coming into and out of side-roads.

Get ready to vote....we don't know the date of the General Election yet but the local elections are on 6th May. The local Polling Station for Rooksdown is Headway Place on Park Prewett Road along from Rooksdown surgery.

Don't forget the new Medical Centre has opened next to the main entrance for the hospital. Access to a Nurse, Doctor or Dentist when you need it from 8am to 8pm 7 days a week. Tel: 01256 477720.

Welcome to Lucy Mackmin the new Rooksdown Community Development Officer and Sarah Ratcliff who is the new Rooksdown Community Safety Patrol Officer for Rooksdown. Goodbye and thank you to Sandy Pearcey who used to be the BDBC contact for Rooksdown. Also a big thank you to Katie John for proof reading the Reporter again.

DISCLAIMER: The views expressed in the Rooksdown Reporter are not necessarily those of the group. We do not accept liability nor warrant any product or service advertised in the Rooksdown Reporter.

ROOKSDOWN PARISH COUNCIL

Charles Miller—Chairman

Rooksdown Parish Council meets monthly (except August and December) in the main hall at Saxon Wood School; please come along and raise anything which concerns you about Rooksdown. A notice of each meeting will be displayed on the notice boards throughout the parish, and dates of forthcoming meetings will also be found on the council's website, www.rooksdow.org.uk, along with minutes of past meetings and other local information.

Following problems reported by a number of residents in the newer areas of the estate, particularly concerning street lighting and the state of roads and pavements, members of the Parish Council have attended a number of meetings with the Developers to ensure that they have an awareness of the problems which residents are experiencing. We are hopeful that this will lead to swifter resolution, although sometimes there are reasons why it is not possible to do this as fast as we would like. For faulty street lights and road problems in adopted roads contact the County Council via www.hants.gov.uk

The owners of the land near Nightingale Gardens, which is used as a football kickabout area, have granted the Parish Council a temporary lease so that it can continue to be used for recreation until it is required for development – the council will arrange for repairs to the pitch surface and adjacent fencing. We are hopeful that the large open space at the hospital end of Rooksdown (near the site of the proposed community centre) will be released by the Summer – a number of steps have to happen first but if all goes well the “Village Green” will become available for informal recreational use.

The seats for the green by the Mill Road roundabout will be installed as soon as consultation with residents in the immediate area has been completed. It is our intention to purchase seats for other areas of the estate in the future; if you would like to suggest a location where you feel a seat would be useful, please contact the Parish Clerk.

The council continues to investigate the possibility of the provision of allotments within Rooksdown – at present there is no land available but we intend to push for the inclusion of allotment land as part of any further development within the estate.

Charles

Chairman, Rooksdown Parish Council

Cllr Karen Cherrett, Rooksdown Borough Councillor

I am often asked the same questions by different people about the things that concern them most. As a result I thought I'd give you an update on the top ten most frequently asked questions for the last few months:

- **What's happening with the street lights in Limes Park?**

Taylor Wimpey confirms that the trenches have been dug in preparation for the power supplier to come and do the necessary connections. Some lighting is connected but the continuing delay is with the power suppliers (who were originally meant to start back in October). We are all chasing a solution.

- **When will we expect to see shops and a community building?**

We are continuing to talk to the developers who disagree with the council, parish and community about the financial viability of shops on the development. We say there is demand and that it's economically viable now but we cannot make the developers build the building. I will keep you posted. As for the community centre, we have got planning permission and look forward to starting to build it this year.

- **When will we get a park for older children?**

Early release of the land at the old hospital cricket pavilion site by developers is being discussed and we hope that it will be brought forward to this year to coincide with the start of preparing land for the community centre.

- **Where will the community centre be?**

On the land between the temporary Rooksdown surgery and the green (old hospital pavilion) where the helicopter lands. The green itself is the land we want released as a village green and play space.

- **What about the big puddle that forms on Rooksdown Avenue?**

This has been a recurring headache with different solutions being tried so far. A solution (putting an additional pipe under the road and deeper soakaways) has been put forward and is on the highways schedule for this year. We hope this will solve the problem.

- **When will we get a more frequent bus service?**

We are currently told by bus operators that Rooksdown is not viable for a more frequent or direct to town service. This is partly because of the size of development and partly because of the different ownership of the roads – roads in the older part of the area are adopted and the responsibility of the Highways Authority, but roads in the newer areas of Limes Park are still privately owned by the developers and the hospital. This will change as the development is progressed and demand increases. Until then we will keep lobbying for a better service.

Cllr Karen Cherrett, Rooksdown Borough Councillor

- **When will the roads and pavements be finished?**

Until roads and pavements are completed and handed over by developers for adoption by the County Council, there is little power to enforce any maintenance. However we are in discussions with the developers about phased adoptions, some as early as this year, so that we don't have to wait for everything to be completed. Site completion could still be 3-5 years away.

- **Why do some of us pay a management charge?**

When the Rooksdown development was less than half built, the government introduced an initiative to collect funds from households on new developments to pay for a residents' management committee. The committee would look after greens and open spaces in the area. The charge only applies to Limes Park and seems to split the maintenance of the estate in two. This doesn't seem to make sense as we already have a Parish Council and Community Association - so we are trying to get all of the area brought under one responsible organisation. Until then, monies already paid are being held in a legal trust by solicitors.

- **Will Rooksdown get any bigger?**

There are areas still to be developed at Rooksdown to complete the originally planned development: land at the old golf course, Aldermaston Triangle (between the A340 and the hospital) and Trumpet Junction (next to Priestly Road) are still earmarked for development. For these areas it is not a question of whether but when development will occur and the Parish Councillors and I will want to know your views through the coming consultations on what sort of development we want to see on this land.

And finally a topical winter question:

- **Should I clear my path when it snows and where can I get grit?**

Homeowners have a duty of care over their premises including safe access to it by visitors. In deciding whether to clear snow or ice the view seems to be that to do so with good intent is fine as long as in doing so you do not make the area more dangerous e.g. using a kettle of hot water on a frozen path will just create a sheet of ice. Anyone wishing to make a claim for damages if they slip has to demonstrate the actions of the householder were negligent and directly contributed to the fall. Ultimately it comes down to using your own neighbourly judgement and common sense. As for grit, rock salt is available from most DIY warehouses although we are lobbying the County Council for grit bins in the area and if this fails the Parish Council may well look to buy and place some.



4th WINKLEBURY CUBS

Spaces Now Available!

We are a long established Cub Pack that now have spaces available for Boys and Girls between 8 and 10 years old

Wednesdays 18:30 till 20:00 – Sycamore Centre, Winklebury

If you are interested in having lots of fun then call us!

Call Ian on 07867 988777 or email: iaherne@yahoo.com

SALT/GRIT BINS IN ROOKSDOWN

Following input from residents and Parish Councillors a list of locations have been submitted to the Borough Council via Maria Miller MP in the hope we can get some grit bins provided. Whilst it is unlikely Hampshire County Council and BDBC will provide them for all our suggested locations, Rooksdown Parish Council (RPC) has resolved to put funds towards those we cannot get through other means. These will be ordered once we know which ones will be funded elsewhere. HCC will however be responsible for filling them. It must be emphasised that the grit is for residents to use on the roads and pavements and not for private use.

However in the meantime RPC does have stored with some Parish Councillors very restricted quantities of grit and sand for emergency use in the event of more bad weather. Please contact the Parish Clerk (details on our website or in this magazine) with details as to the location with problems and he will contact the Councillors who are storing the grit/sand.

We do urge residents to continue to help and support each other during the bad weather and getting together to clear your local vicinity is a great way to get to know your neighbours as happened in some areas of Rooksdown.

If you are forced to abandon your car please do so in a safe location and not at road junctions or roundabouts where anyone skidding is likely to cause damage to their own vehicle and yours. Finally please remove it at your earliest possibility so that road clearing efforts can be undertaken without hindrance.

Colin

Rooksdown Parish Councillor

Clr Stephen Reid, Rooksdown County Councillor

The positive news that came out of the snows in December and January was that there is a huge pool of goodwill in the community to get out and help at difficult times. I discussed this with the Rooksdown Parish Council and, as a result, have used part of my 'County Councillor's grant' to fund the purchase of winter equipment: some snow shovels which the Community Association will be able to deploy next time round. This particular grant has given me great pleasure: it's only a few hundred pounds but if it helps people to be good neighbours, that's such a positive outcome.

I have also been pleased to help the Hospital Radio again: mainly volunteers, who do such an important job for the morale of patients.

The Rooksdown Community Centre looks to be under way at long last with the planning application approved. I was particularly pleased that the designs changed as a result of the public consultations: they are much better now.

ROOKSDOWN COMMUNITY ASSOCIATION

The first events of this year will be our Easter Disco , followed by the Woodland Walk on the 8th of May and our annual Summer Fayre in July, this year we are hoping to have a BBQ. Keep a look out for details on the notice boards, flyers through your letter box and banners around Rooksdown.

We are constantly looking for ideas for new events. Our new aim is to hold an event for dog owners and a walk to the local pub (just over a mile away). If you feel that you are in a group that is being over looked or have some inspiring ideas please contact us.

Members of the Community Association took part in the Mayors Bowling to raise money for charity. The Rooksdown Rookies unfortunately came in very near the bottom. We did have a great time and around five thousand pounds was raised for Haiti.

Look forward to meeting you all at the events or please come along to the meeting.

Dellie

Chairman of Rooksdown Community Association

ROOKSDOWN BEAT PC 2521 Ian Hoile

Tip from Hampshire Constabulary re getting home safe at night:

PLAN:

P – Prepare. Know how you are getting home, pre-book a taxi and let someone know where you're going. Make sure you have enough credit on your mobile phone for emergencies.

L – Look confident. Someone clearly under the influence of alcohol looks more vulnerable.

A – Act to avoid risk. Think twice before accepting drinks from someone you don't know well and never accept lifts from cruising cars or cabs.

N – Never assume it will never happen to you. Trust your instincts; they are there to warn you of danger.

Tarren Porter is the PCSO for both Rooksdown and Winklebury . He can be contacted on 0845 0454545 or tarren.porter@hampshire.pnn.police.uk

Ian Hoile (PC 2521 Ian Hoile) is the Rooksdown Beat Policeman . He can be contacted on 0845 0454545 or Ian.hoile@hampshire.pnn.police.uk

NEIGHBOURHOOD WATCH

Several Neighbourhood Watch Schemes have been set up in Rooksdown and it is hoped that more schemes will follow . If you wish to join a scheme or set one up then please contact Paul Green on 0845 0454545 or email via the link below: www.hampshire.police.uk

It is important that we all work together, and if you do notice anything suspicious please report it immediately by ringing 999. (Most mobile phones have 112, 999 and 911 as pre-programmed emergency numbers that are always available.) For non-emergency calls, you can call 101 (this number will not work on some mobile phone networks) or 0845 045 45 45 which puts you through to the Police control room. (min charge 10p)

PLEASE DON'T LEAVE IT TO SOMEONE ELSE TO CALL



FREE COLLECTIONS OF ELECTRICAL WASTE
www.weecollect.it or Tel: 0871 2000 962

ROOKSDOWN COMMUNITY DEVELOPMENT OFFICER - Lucy Mackmin

A new team who will be working with residents and local groups to make their neighbourhoods even better places to live has been introduced by BDBC.

From Monday 4 January, the Council's new team of Community Development Officers have been working across the borough, spending the majority of their time based in the communities they cover. Lucy Mackmin will be working in Rooksdown.

The role of the Community Development Officers is to work with residents to identify what is needed in their areas, for example youth clubs, children's holiday programmes, lunch clubs for older residents or exercise sessions to promote healthier lifestyles.

Part funded by Sentinel Housing Association and Kingfisher HVHS Housing Association, the team will be a key link to bringing together public bodies, the voluntary sector, local businesses and the community. Focussing on helping local communities to find their own solutions to issues, they will work closely with residents, community groups, schools, churches and local service providers.

"The team's first priority will be finding ways of addressing gaps in community activities that have already been identified. But they are encouraging residents who have ideas about community projects to benefit their local area to get in touch with the Community Development Officer covering their area.



If you would like to contact Lucy, please call her on
Lucy.Mackmin@basingstoke.gov.uk or telephone 07775413251

FHC FOR HAIR Fundraise for St Michaels Hospice

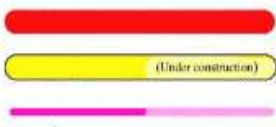
FHC for Hair in Winklebury put on their 5th annual Hair show to raise funds for St Michaels Hospice on 8th February at the Sycamore Centre. They had 27 models and a Dance Theme to show off their interpretation of current hairstyles. They raised £1450.00.



A339 Newbury to Basingstoke
Local Roads
 (Under construction)
Main Footpaths / Cycleways

-  **Site of proposed community centre**
-  **Site of Wessex Christian Fellowship church**

Street Plan

Rooksdown C

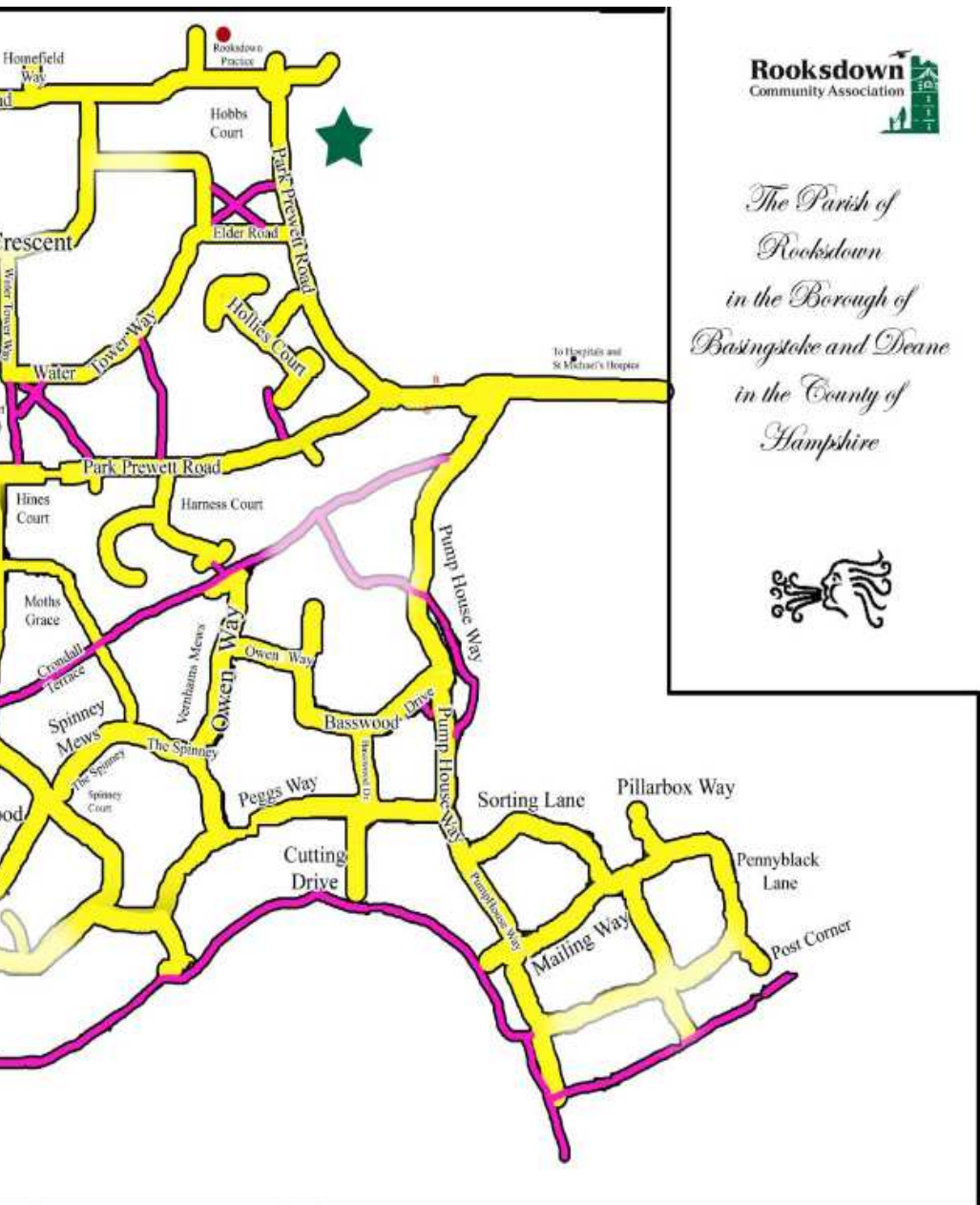

*The Parish of
Rooksdown
in the Borough of
Basingstoke and Deane
in the County of
Hampshire*



of Rooksdown
Community Association

- B** - Bus stop offering an infrequent service to/from Basingstoke
- B** - Bus stop offering a frequent service to/from Basingstoke
(Monday to Saturday daytime)

Issue: 2010/01

THE ROOKSDOWN WESSEX CHRISTIAN FELLOWSHIP CHURCH

Progress is being made by the Wessex Christian fellowship with their purchase of the old Rooksdown Park Hall, which they are going to convert into their new church.

They are to start work with their builders this Summer and they are hoping to occupy the building either late 2010 or early 2011.

WALK 4 LIFE - WALKING THE WAY TO HEALTH

Come and join our walk on 23 June at 7pm meet us at the Haemophilia Centre Car Park, Aldermasten Road, opposite St Michael's Hospice (no need to book). The walk leaders are Julia Phillips & Miriam Elliot.

Please wear clothes and shoes suitable for the weather and bring a bottle of water. (NB/ A Brisk walk of about an hour.)

Would you like to become a volunteer walk leader?

A free fun one-day course (or 2 evenings) that will enable you to lead safe enjoyable walking sessions for all ages and abilities. If you enjoy meeting people, like walking and have some spare time, we would like to hear from you.

Please phone Jane Wilding 01256 845574 quote 'Rooksdown'



COMMUNITY SAFETY PATROL TEAMS

New Community Safety Patrols hit the streets of the Borough on Friday 12 February. The team will work closely with the community to identify and tackle issues reducing crime, deterring anti-social behaviour to make residents feel safer and happier about their neighbourhood.

They will be working closely with the Police with daily combined meetings. The CSPO can tackle offenses such as graffiti, littering, dog fouling and confiscating alcohol from underage drinkers.

The Rooksdown Community Safety Patrol Officer
Sarah Ratcliff Tel: 01256 844 844

FIRE BRIGADE - Officer Ryan Thurman
Hampshire Fire & Rescue Service: www.hantsfire.gov.uk

Stay Safe On The Roads.

Don't drive tired –

Plan in a 15 min rest break for every 2hrs of driving.

Avoid making long trips between midnight- 6am and 2-4pm when natural alertness is low.

Share the driving if possible.

Don't drink drive –

Nearly one in six of all deaths on the road involve drivers who are over the legal alcohol limit.

The only safe option is not to drink any alcohol if you plan to drive and never offer an alcoholic drink to anyone else who is driving.

Driving whilst above the legal limit or unfit through drink carries a maximum penalty of 6 months' imprisonment, a fine of up to £5,000 and a minimum 12 months driving ban.

Don't use your mobile phone while driving –

On 27 Feb 2007, the £30 fine was increased to £60 and three penalty points on your licence. Penalty points = higher insurance costs.

If you get six points within two years of passing your test, your licence will be revoked and you will need to re-sit the test.

If the case goes to court, you could risk a maximum fine of £1,000, which rises to £2,500 for the driver of a bus, coach, or heavy goods vehicle.

Always buckle up -

Drivers and front seat passengers in cars must wear a seat belt, unless they have a medical exemption certificate.

Children under the age of 14, travelling in the rear of a car that has appropriate restraints, must belt up.

Adults travelling in the rear of a car must also use seat belts, it is the responsibility of the adult passenger (not the driver) to ensure that they are using the seat belt.

Email: community.firesafety@hantsfire.gov.uk

There is now a **ROOKSDOWN FACEBOOK** group for all our residents, feel free to join and join in the discussions.... <http://www.facebook.com/group.php?v=info&gid=144658528115#!/group.php?gid=144658528115> (or search for Rooksdown, Basingstoke)

ROOKSDOWN ADVERTISING

INDOOR BOWLS

Try it!

You'll like it!

It's friendly, it's fun

Open 7 days a week from 10am to 10pm. So why not give it a try.

Coaching is free and bowls are supplied. Lots to gain, nothing to lose.

Call us and we'll give you all the information and help you need.

Loddon Vale Indoor Bowls,

Leisure Park

Churchill Way West, Basingstoke

RG22 6PG

Tel: 01256 356507

www.loddonvaleibc.co.uk

Email info@loddonvaleibc.co.uk

MH AUTOS

Unit 11 Vickers Business Centre

Priestly Road, Rooksdown

Servicing, MOTs and Pre MOT

Free collection & delivery

For a friendly and professional service call

Mark 01256 467707 or

07879 638650

ROOKSDOWN'S MILKMAN

Dairy Crest will deliver your milk, juice, potatoes, eggs and even your Basingstoke Gazette. Why not give them a call on

01256 321329

You can now order your shopping online www.milkandmore.co.uk

GREENWAYS NEWSAGENTS

We deliver newspapers direct to your home. We deliver 7 days of the week. Why not have that extra time cuddled up in bed and let us do the running around for you.

Winklebury Centre, Basingstoke,

Tel: 01256 328840

and ask for Barry or Jackie

RADIO BASINGSTOKE

Listen live 24 hours a day to your local internet radio station.

www.radiobasingstoke.co.uk

Tel Astrid:01256 810764

Email:

astrid@radiobasingstoke.co.uk or

BOPPING BABIES

Bopping Babies is a disco fun, dance and play session for 0-5s. Sessions held 1st Wednesday monthly at Bramley Village Hall and 1st & 3rd Thursday monthly at Chineham Village Hall. Available to hire for kids parties from ages 1 to 10!

Contact 01256 884150 or info@boppingbabies.co.uk.

LMC CHILDMINDING

Fully trained childminder, with 8 years teaching experience, located in Rooksdown.

Places available 0-5years.

Flexible Hours to suit

Tel Lisa: 01256840701

ROOKSDOWN ADVERTISING

ROOKSDOWN MEDICAL CENTRE

Park Prewett Road
Rooksdown, RG24 9RG

DOCTORS SURGERY

Tel:01256 399710

OPENING HOURS:

Mondays 8.00am until 7.30pm
Tuesday to Fridays 8.00 until 6pm

ROOKSDOWN PHARMACY

Tel: 01256 320303

OPENING HOURS:

Mondays 8.00am until 7.30pm
Tuesday to Fridays 9.00 until 6pm
Saturdays 9.00am until 12.00

Rooksdown Pharmacy is a family run business, a husband and wife team that provide a friendly, efficient service to the local community with a personal touch.

Some of the services provided are:

- Blood Pressure screening
- Diabetes screening
- Cholesterol screening
- Stop Smoking Clinic
- Repeat Prescription Collections

BASINGSTOKE PLAY LTD

Basingstoke Play Ltd (The Play Council) offer after school and holiday care for school age children

For more information ring:
01256 844847

BEAVERS,CUBS & SCOUTS

4th Basingstoke—Winklebury
At the Sycamore Centre
(open to girls and boys)

BEAVERS Tuesdays 6-7.15pm

Age 6 to 8yrs

Martin Potts 07948 730192

CUBS Wednesdays 6.30-8pm

Age 8 to 10 1/2 years

Ian Aherne 07867 988777

SCOUTS Tuesdays 7.30-9.30pm

Age 10 1/2 to 14 years

Julie Gray 07833 926231

FHC FOR HAIR

Elmwood Parade
01256 464392

A Healthy Scalp = Healthy Hair
Our amazing new Microscope &

Camera allow our highly trained staff to get to the root causes of thinning hair, hairloss, dry, itchy and flaky scalps.

Free consultations and £5.00 off your first treatment on presentation of this advert. Offer ends 30 April 2010. Treatments start from £25.00

ANNIE

For embroidery of all types, names and pictures. Call me: 07745625160

AVON

_Looking to earn some extra cash?
I'm looking for Avon reps in the local area, please
email: Ailsa.cordner@gmail.com

ROOKSDOWN COMMUNITY BUILDING

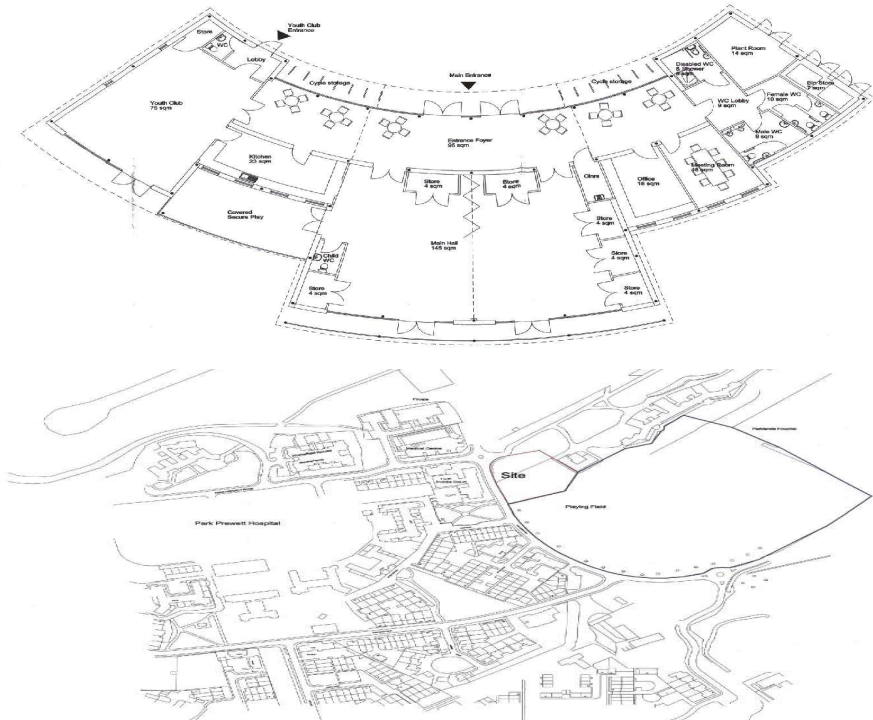

Planning permission for the new Rooksdown Community Building has been approved. Hopefully we will see signs of building starting soon and with a bit of luck it should be up and running early next year.

If you would like to view more details on the plans follow the link below:

www.basingstoke.gov.uk

Planning and Transport

Planning Applications

Start a new Search

Type in Application Number: BDB/71767

Select BDB/71767

Documents

This will allow you to view the plans for the Building and immediate surrounding area.

NICKY'S BANANA BRIOCHE PUDDING

By Nicky Young

Ingredients

1 x large Brioche Loaf
 4 x small bananas or 3 x large
 200g Plain Chocolate
 8 Tablespoons of Baileys (you can buy miniatures bottles)
 570 ml sour cream (2 x 1/2 pint tubs)
 4 eggs

- Slice the loaf and cut into small squares using a sharp knife, put half of these into the bottom of an oven proof dish with sides about 25-30cm in diameter.
- Slice the bananas and put half on top of the brioche.
- Roughly chop the chocolate using a chopper if you have one, sprinkle half of the chocolate over the bananas and repeat in layers until all the brioche banana and chocolate are in the dish.
- Whisk together the 4 eggs, then add the sour cream and Baileys and mix well.
- Pour over the pudding and gently ease down so that it reaches the bottom layers. Leave to soak for 10 minutes before putting into the oven.
- Bake in the oven on 180 C for about 20-25 minutes until golden brown.

This is a lovely pudding if you have family or friends round, and takes minutes to put together. Its even better if it cooked in a Pampered Chef stone dish, but any ovenproof dish will do. Pampered Chef are manufacturers of high quality cook wear, please contact me if you would like to know more or take a look at my website.

Nicky Young

Tel: 01256 429560

14 Vespasian Gardens, Rooksdown

www.pamperedchef.biz/nickyyoung

HAMPSHIRE HEALTHCARE CENTRE at Basingstoke Hospital

Easy access to a NHS nurse, doctor or dentist from 8am to 8pm

7 days a week.

Prebookable and same day treatment available. Appointments are not always necessary.

Tel: 01256 477720

[Www.hampshirehealthcarecentre.nhs.uk](http://www.hampshirehealthcarecentre.nhs.uk)

USEFUL ROOKSDOWN CONTACT DETAILS

Parish Council	www.rooksdowndown.org.uk Email: council@rooksdowndown.org.uk or rooksdowndownclerk@thedarleys.co.uk Tel: 01256 356701 Ron, Parish Clerk	
Community Association	www.rooksdowndown.org.uk/community Tel: 0771 7599819	
Borough Councillor	Karen Cherrett Email: cllr.karen.cherrett@basingstoke.gov.uk	
County Councillor	Stephen Reid Tel: 01256 320860 Email: Stephen.reid@hants.gov.uk	
Police	Ian Hoile	Tel: 0845 045 4545
Neighbourhood Watch	Paul Green Email: paul.green@basingstoke.gov.uk	
Rooksdowndown Reporter	Editor@rooksdowndown.org.uk	
Hampshire Healthcare Centre	Tel: 01256 477720	
Rooksdowndown Pharmacy	Tel: 01256 320303	
Member of Parliament	Maria Miller	Tel: 02072 195749
Hampshire County Council	Tel: 01962 841841	
Basingstoke & Deane Borough Council	Tel: 01256 844844	
Trading Standards Rapid Response	Tel: 01962 946232	
Bus Enquiries (Basingstoke)	Tel: 01256 464501	
North Hampshire Hospital	Tel: 01256 473202	
Electricity Emergency	Tel: 0845 770 8090	
Gas Emergency	Tel: 0800 111 999	
Water Emergency	Tel: 0845 602 1724	
Castle Hill Junior School	Tel: 01256 473777	
Winklebury Junior School	Tel: 01256 323244	
Library Van Information	Tel: 01256 844844	
Community Fire Safety Dept	Tel: 02380 626809	
Graffiti & Fly Tipping	Tel: 01256 844844	
Crimestoppers	Tel: 0800 555 111	

ROOKSDOWN MEETINGS FOR 2010

ROOKSDOWN PARISH COUNCIL MEETINGS 2010

Saxon Wood School at 7.30pm

Monday 29 March
Monday 26 April
Monday 24 May
Monday 28 June
Monday 26 July
Monday 27 September
Monday 25 October
Monday 22 November

ROOKSDOWN COMMUNITY ASSOCIATION MEETINGS 2010

Saxon Wood School at 7.30pm

Tuesday 30 March
Tuesday 27 April (AGM also included)
Wednesday 26 May
Tuesday 22 June
Wednesday 28 July
Tuesday 28 September
Wednesday 20 October
Tuesday 23 November



CALLING ALL DOG WALKERS

The Rooksdown Community Association would like to hold an event for the Dog Walkers in Rooksdown. We thought a sponsored Dog Walk or just a walk in the woods around the perimeter of Rooksdown one Saturday morning. Would you be interested joining us if we did one? Maybe in June (the date is flexible at the moment)

If you are interested please let me know:

Jayne Tel: 07891530444 or email: Jayne.grey@virgin.net

ROOKSDOWN EVENTS 2010



ROOKSDOWN CHILDRENS EASTER DISCO SATURDAY 10TH APRIL

Saxon Wood School, Barron Place, Rooksdown
4.00pm to 5.00pm (under 7's)
5.30pm to 7.00pm (over 7's)



There will be tea and coffee available for the adults and a tuck shop for the children. We are also hoping to have a few stalls available for the adults to browse through. **Entry£1.00.** If you would like to help please ring Jayne on 07891530444.

Rooksdown Community Association will not be responsible for any child attending the community disco. Children under the age of 8 must be accompanied by an adult at all times. Children aged 8 and over will be able to leave at any time and will therefore not be the responsibility of the Community Association, but will be required to provide an emergency contact telephone number upon entry.'

There is also a prize at each disco for the best Easter Bonnet or Hat



ROOKSDOWN WOODLAND WALK SATURDAY 8TH MAY

Mill Road Green
2.00pm to 4.00pm

Come along and enjoy a walk in the woods and our Fun & Games on the Green. This is a free event. There are free drinks of squash and biscuits for all walkers. (There will be a few stalls available with items for Sale and also a sweet stall)

ROOKSDOWN SUMMER FAYRE SATURDAY 10 JULY

Mill Road Green
2.00pm to 4.00pm



Would you like to have a stall at the Summer Fayre or help run a game or activity we would love your help or your ideas.

Please call Jayne 07891530444 or
Email: Rooksdown.Community@hotmail.co.uk

The Rooksdown Community Association are also hoping to be able to run some play sessions during the School Holidays, starting at Easter. We don't have any dates available yet, as soon as we do we will advertise them on the Rooksdown website, Gazette, posters (hopefully one in each street) and on the notice boards around the estate. Please look out for them.